

Printer Info:

Canon imageRUNNER ADVANCE 715iFZ III
BME-MR5-C715.bme.virginia.edu

Questions:

Email: BME-ITSupport@virginia.edu
Call: Henry @ 4-8065 or Tracy @ 4-5193

Copy instructions:

Press **Copy**:

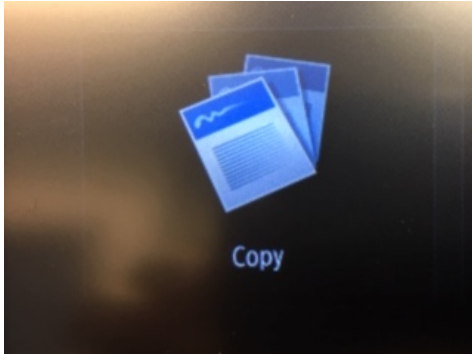

Press **User Name**:

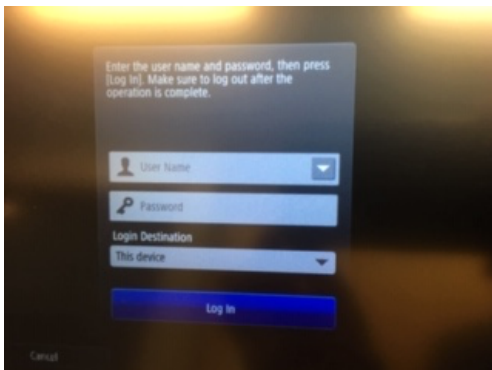

Enter Office or Lab code and press **Next**:

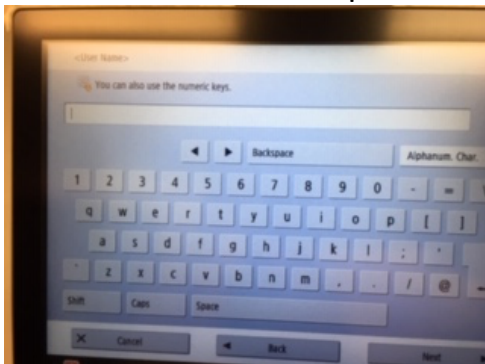

Press **OK**, Press **Log In**.

Put pages to be copied on flatbed or in ADF and press **Green Start Button**.